

Box à Vélos Berlin - Initial "A"

Portes Galva : Réf.529450

Portes Peinte : Réf.529451

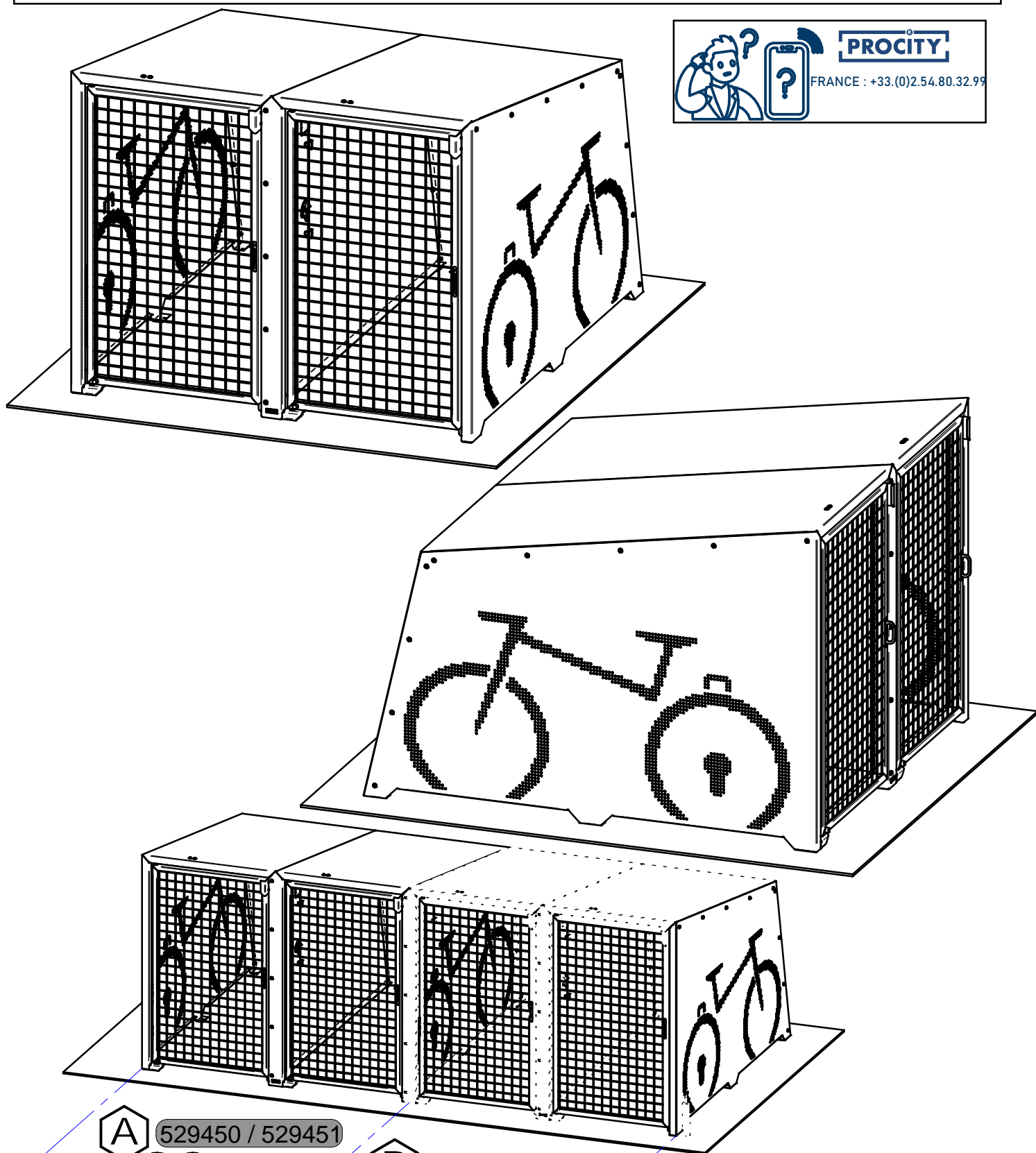

529450 / 529451



N°929



529452 / 529453



N°930

Option Box à Vélos Berlin

Rail au Sol (La Paire) / Arceau Antivol (La Paire)

Réf.529455

Réf.204739

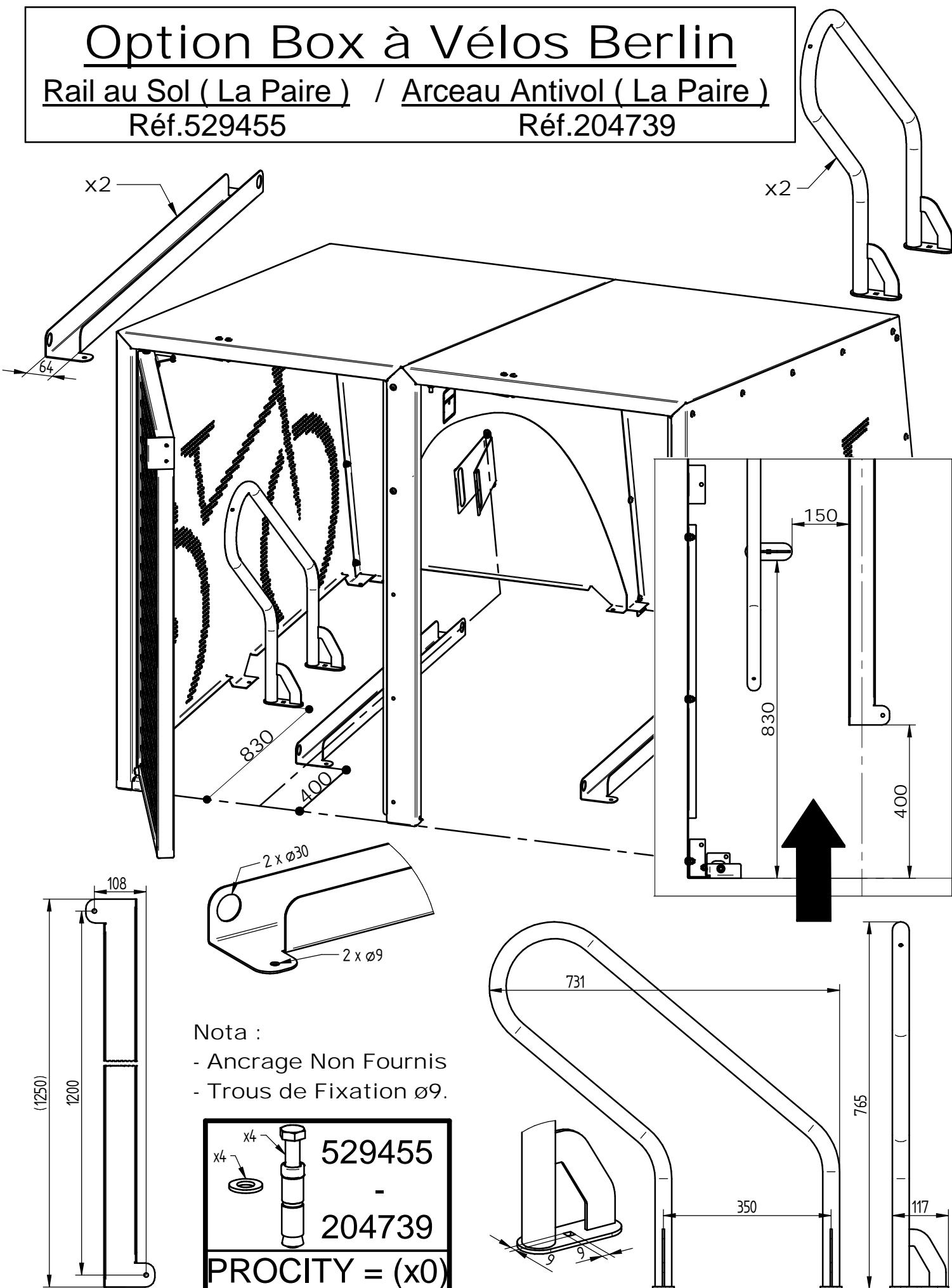

Nota :

- Ancrage Non Fournis
- Trous de Fixation Ø9.

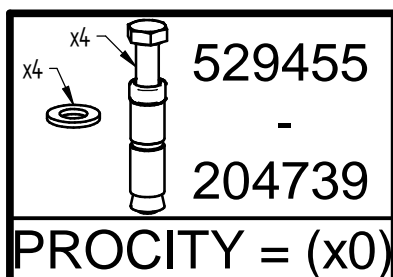

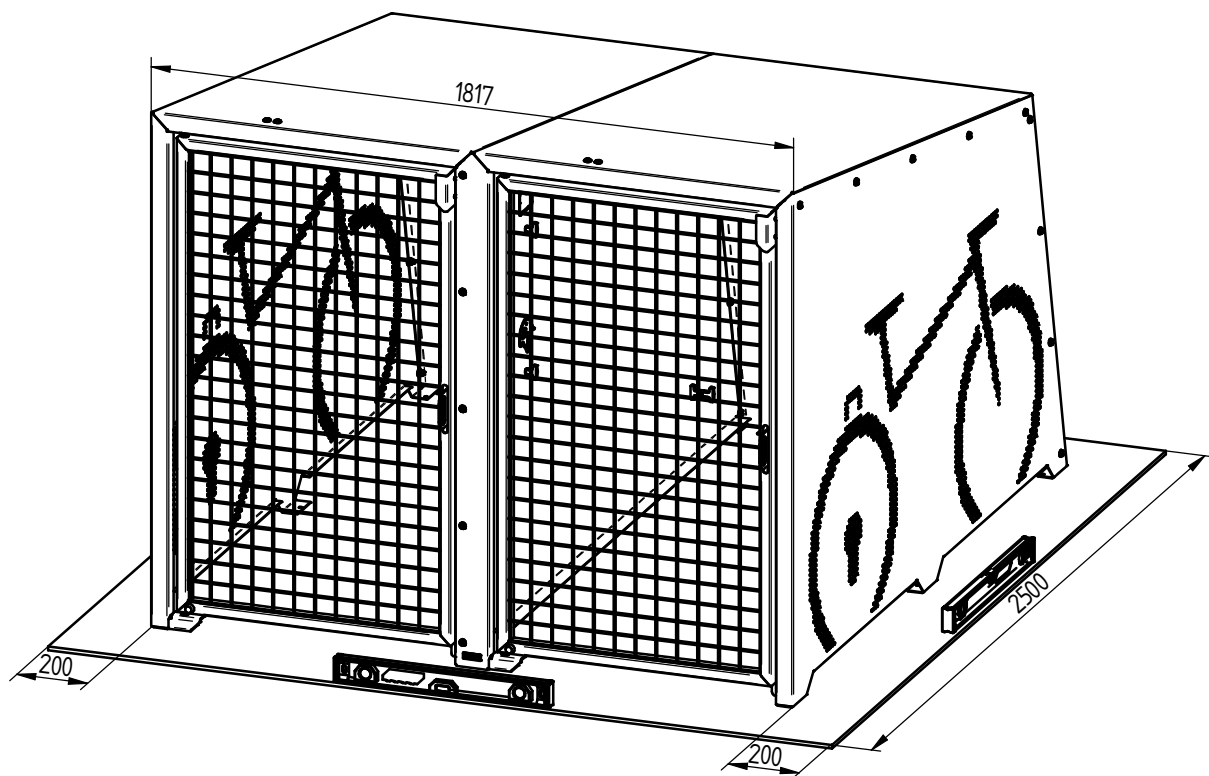

Nota :

- Ancrage Non Fournis - Trous de Fixation $\varnothing 9$.
- Prévoir une Dalle Plane pour la Réserve de l'Ensemble.

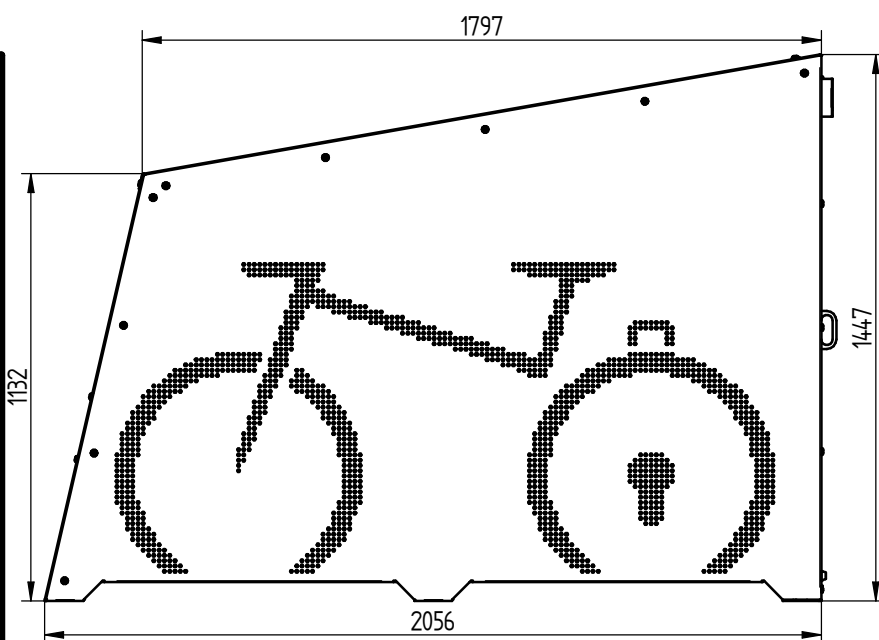
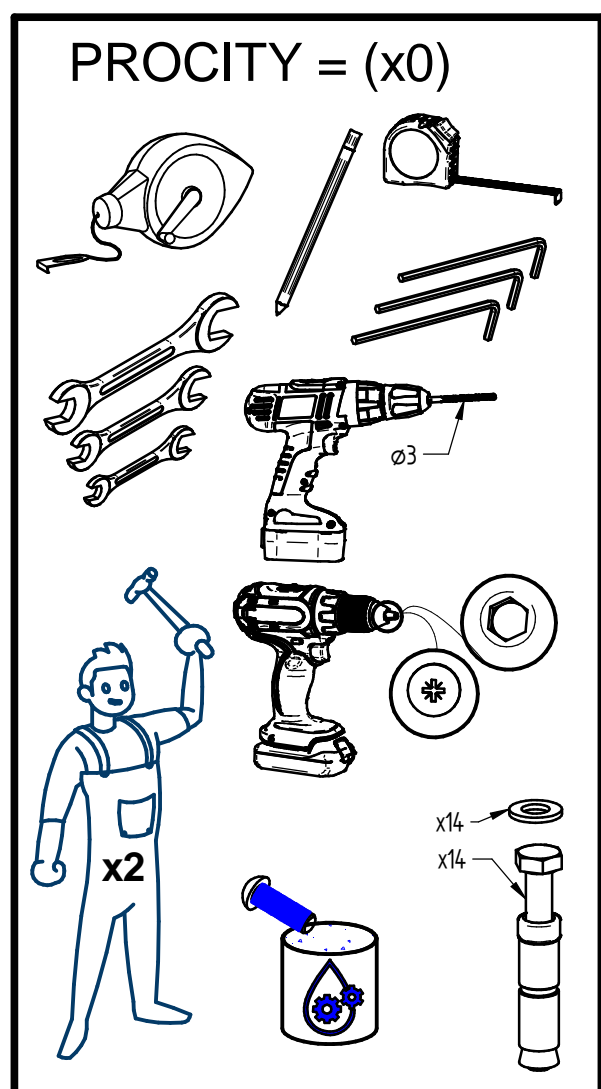



$$N^{\circ}929 = 1 \times 529450 + 0 \times 529452$$

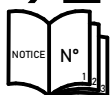

AR

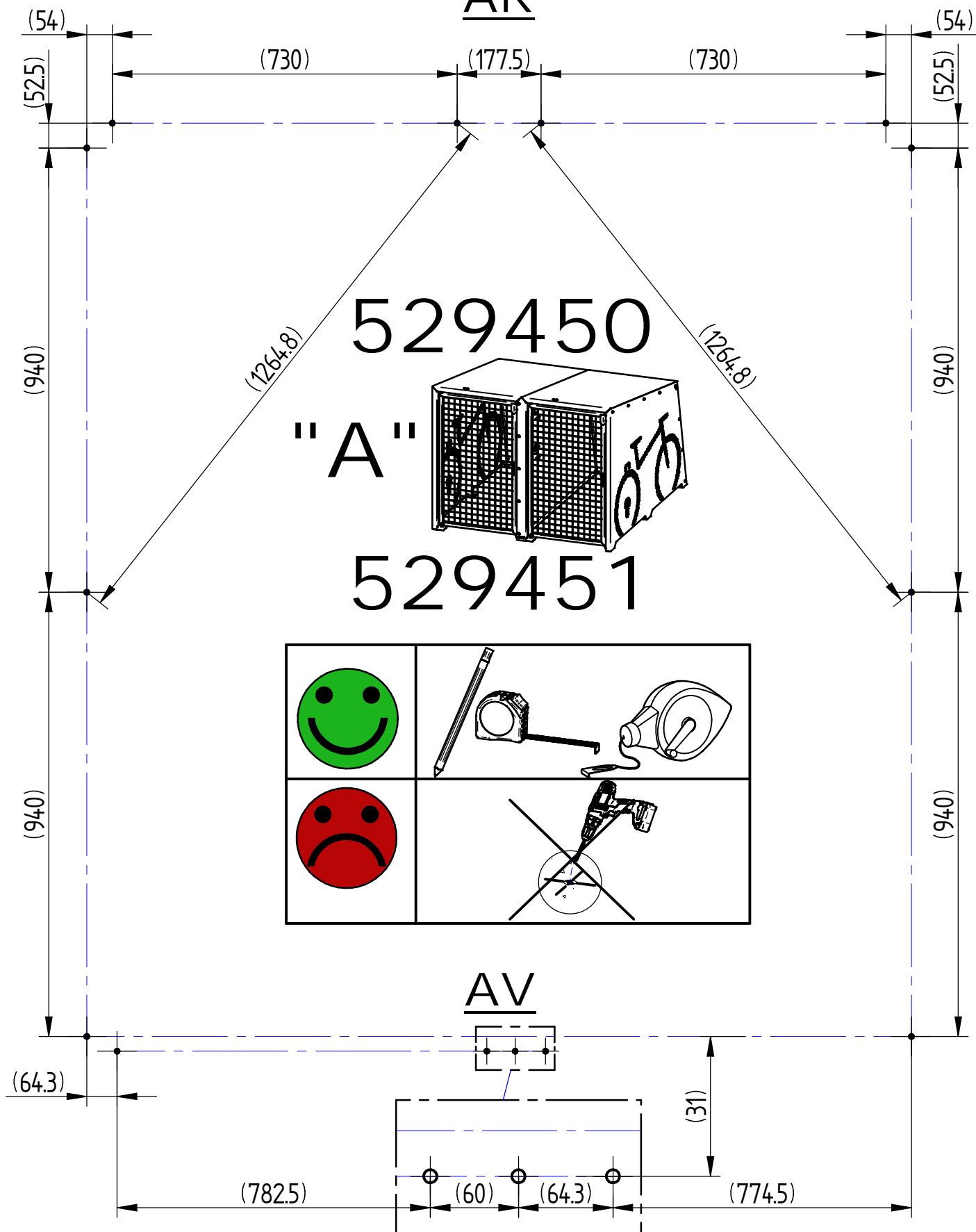

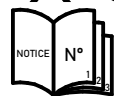

N°929

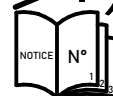

N°930

AR

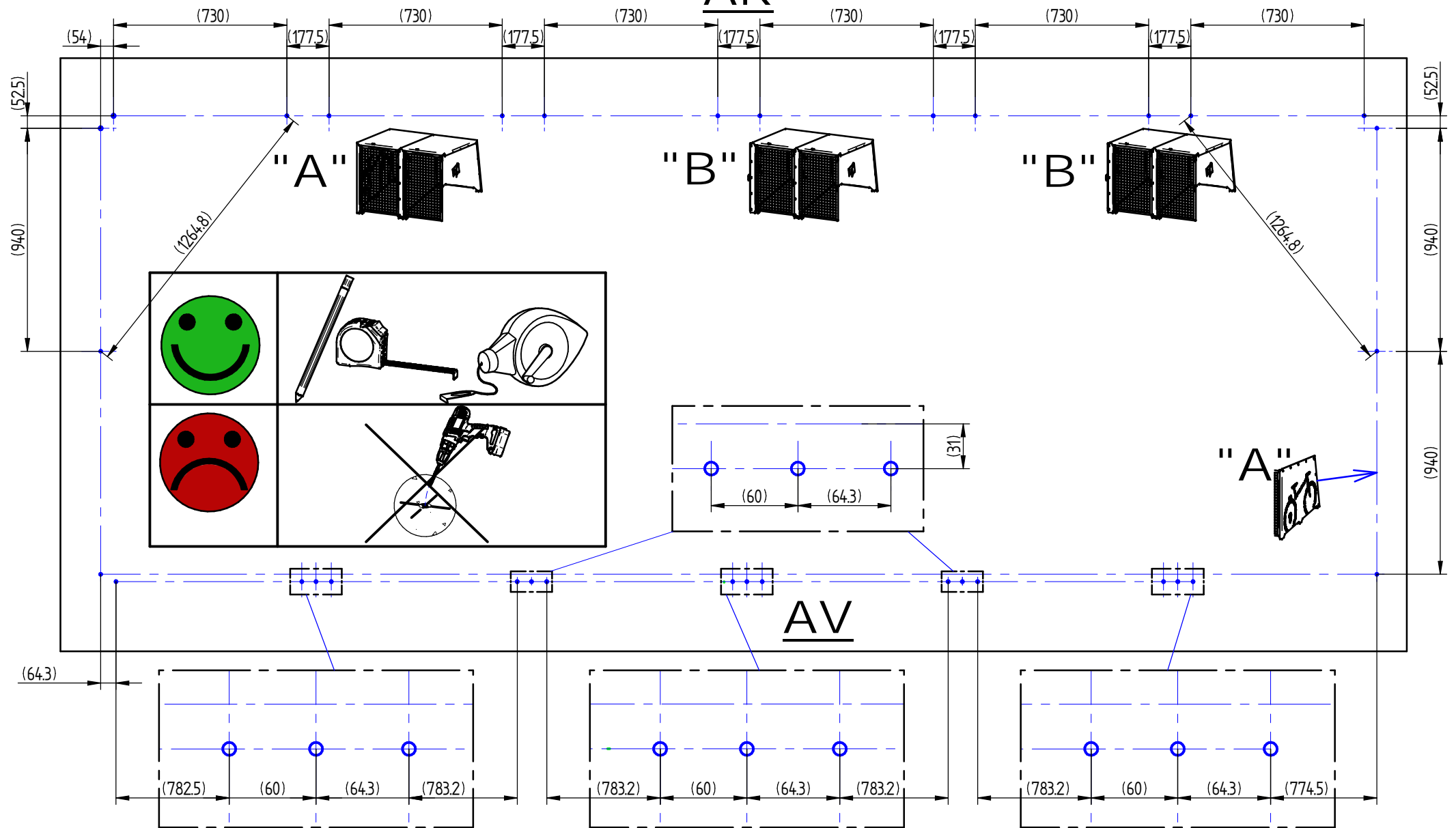

D 701 Box à Vélos - Initial

- Version 03 - 13/05/2025 - Page 6 /18- **N°**

929-V3



PROCITY

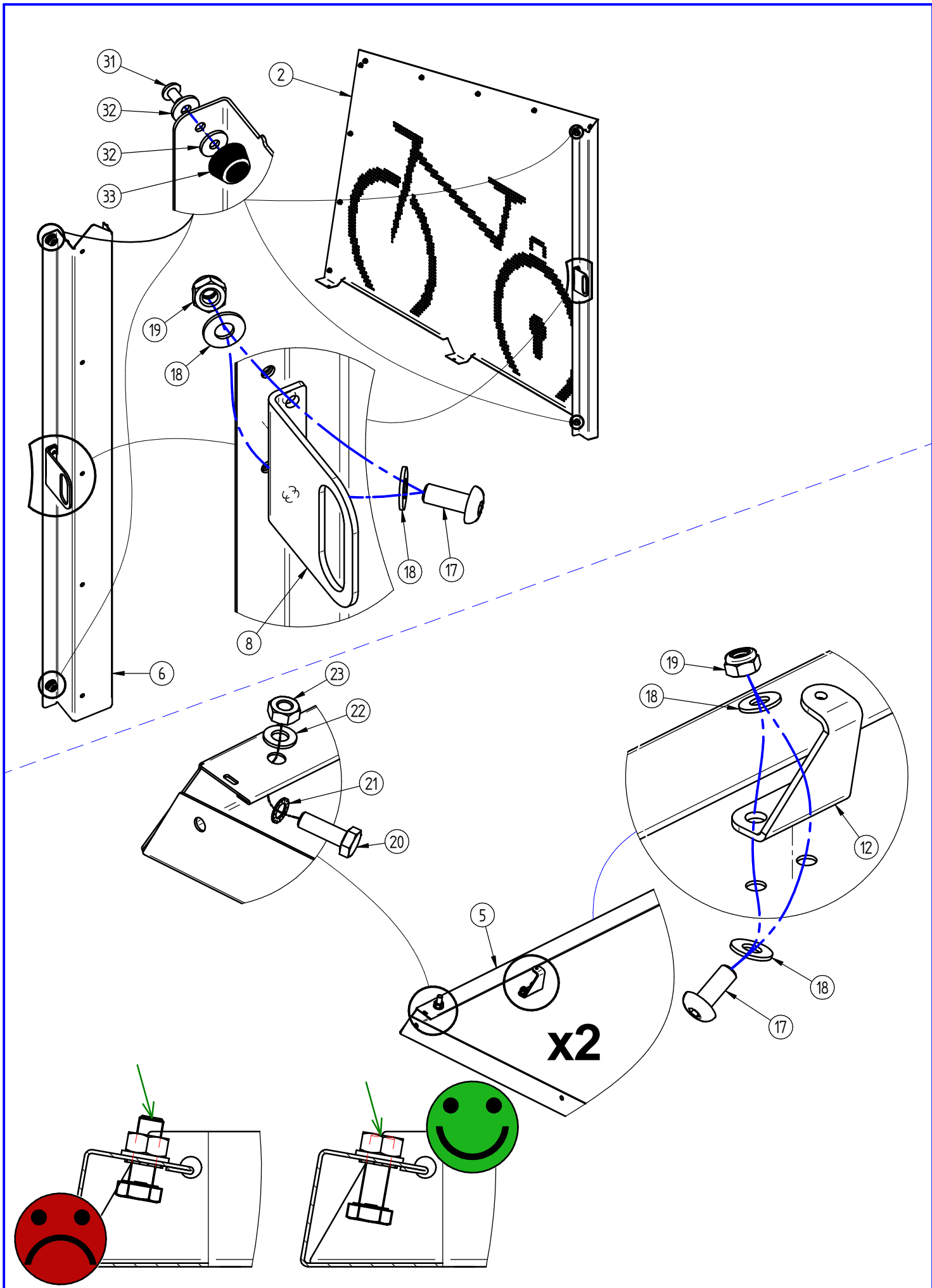

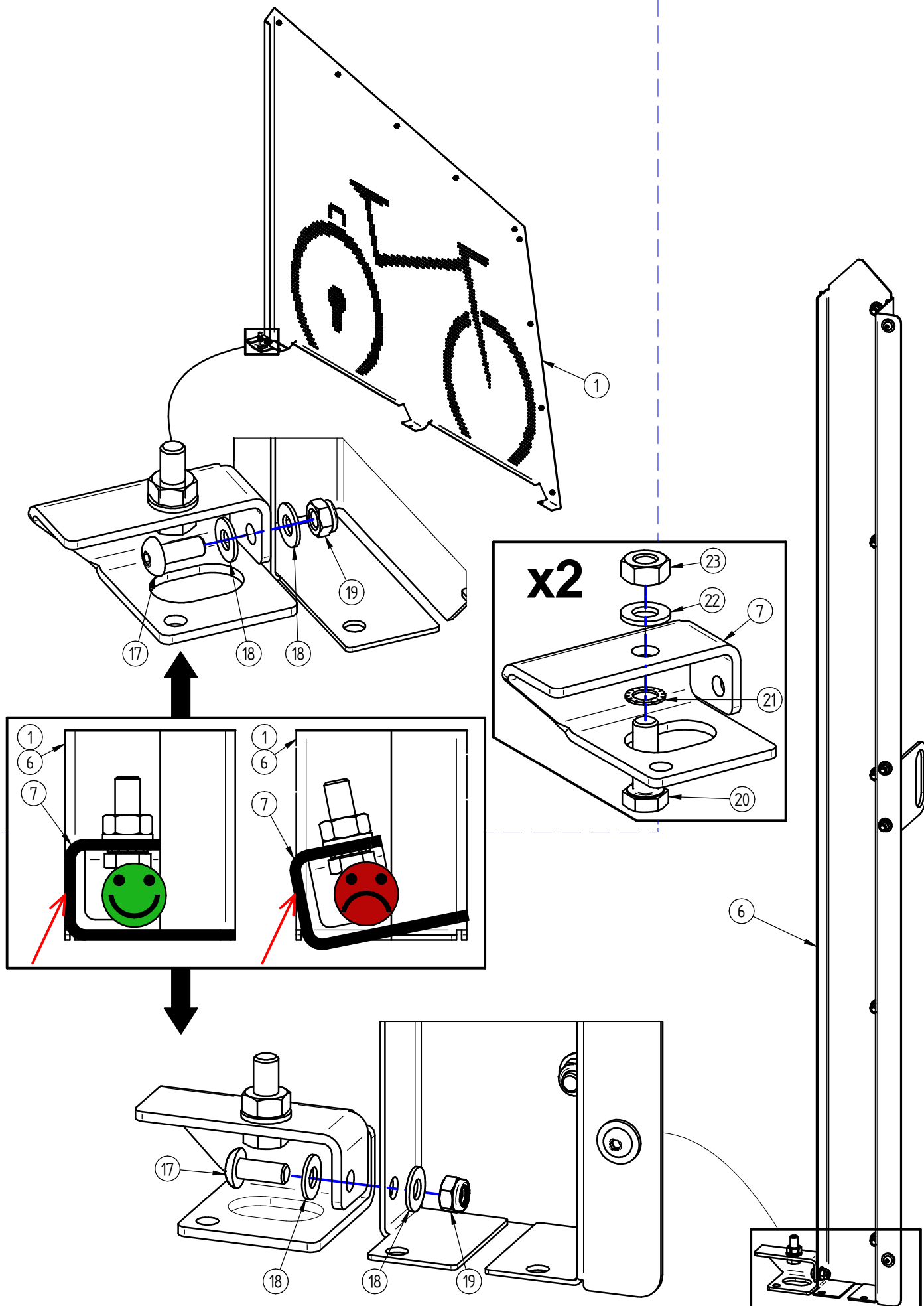

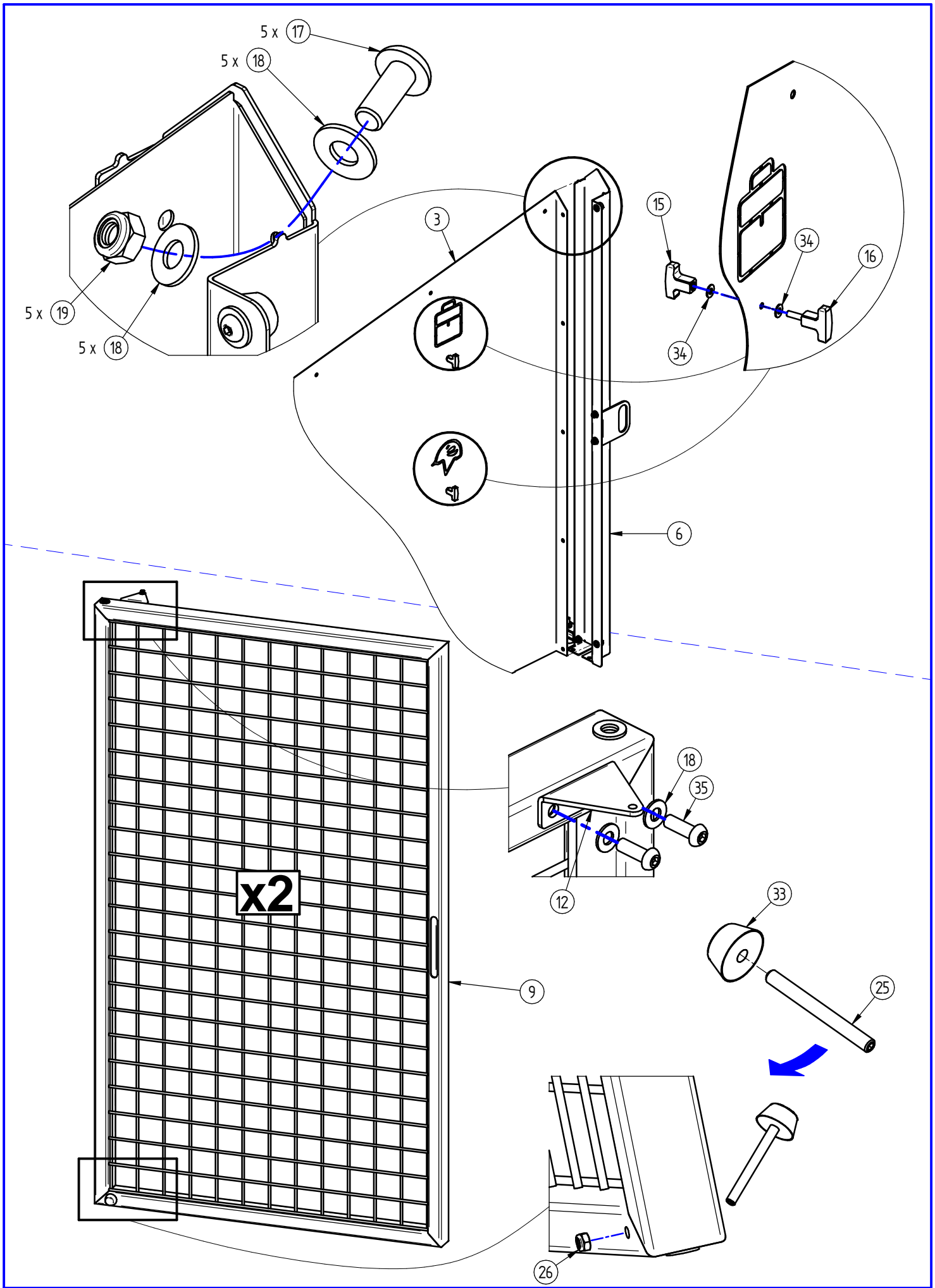

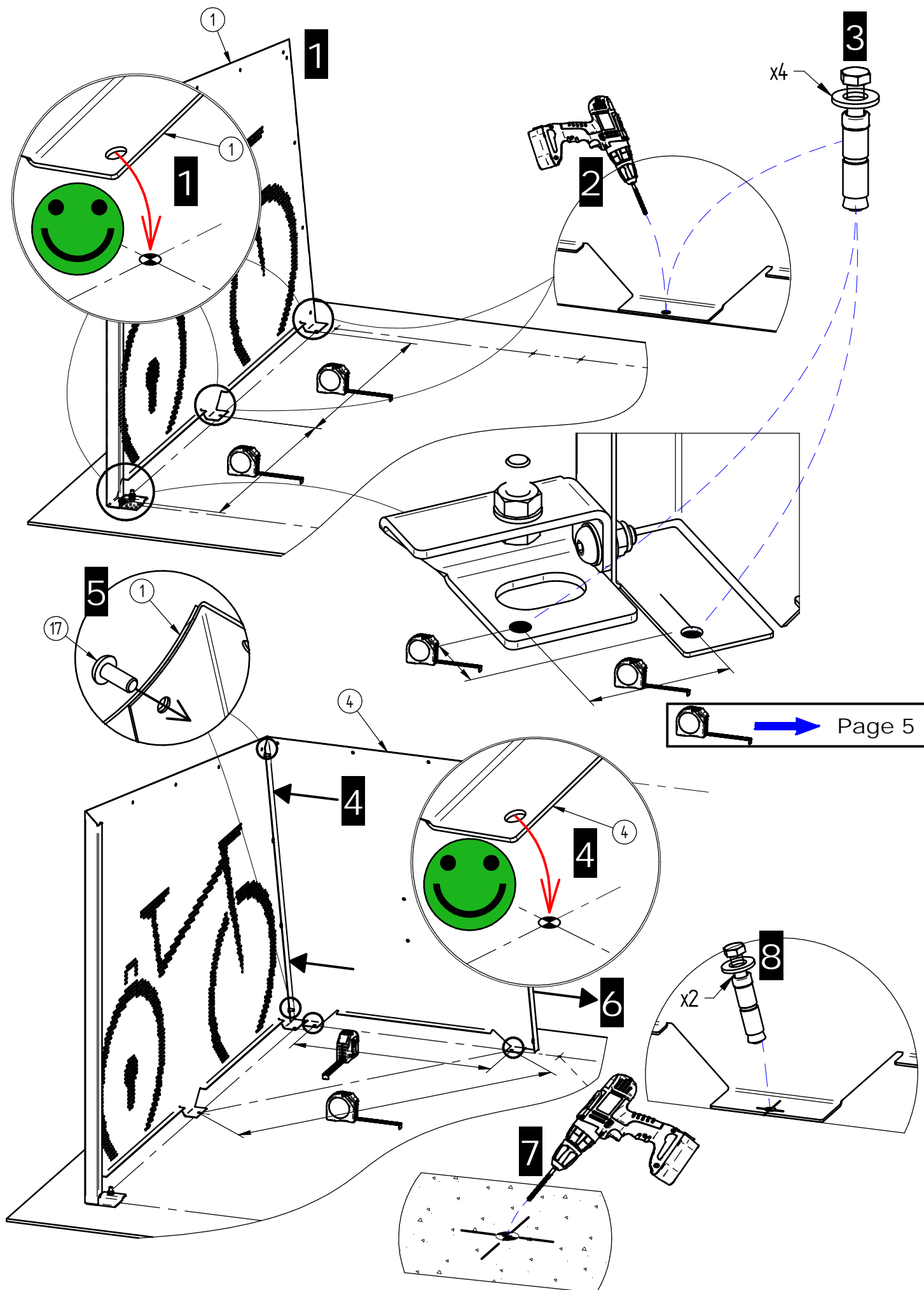

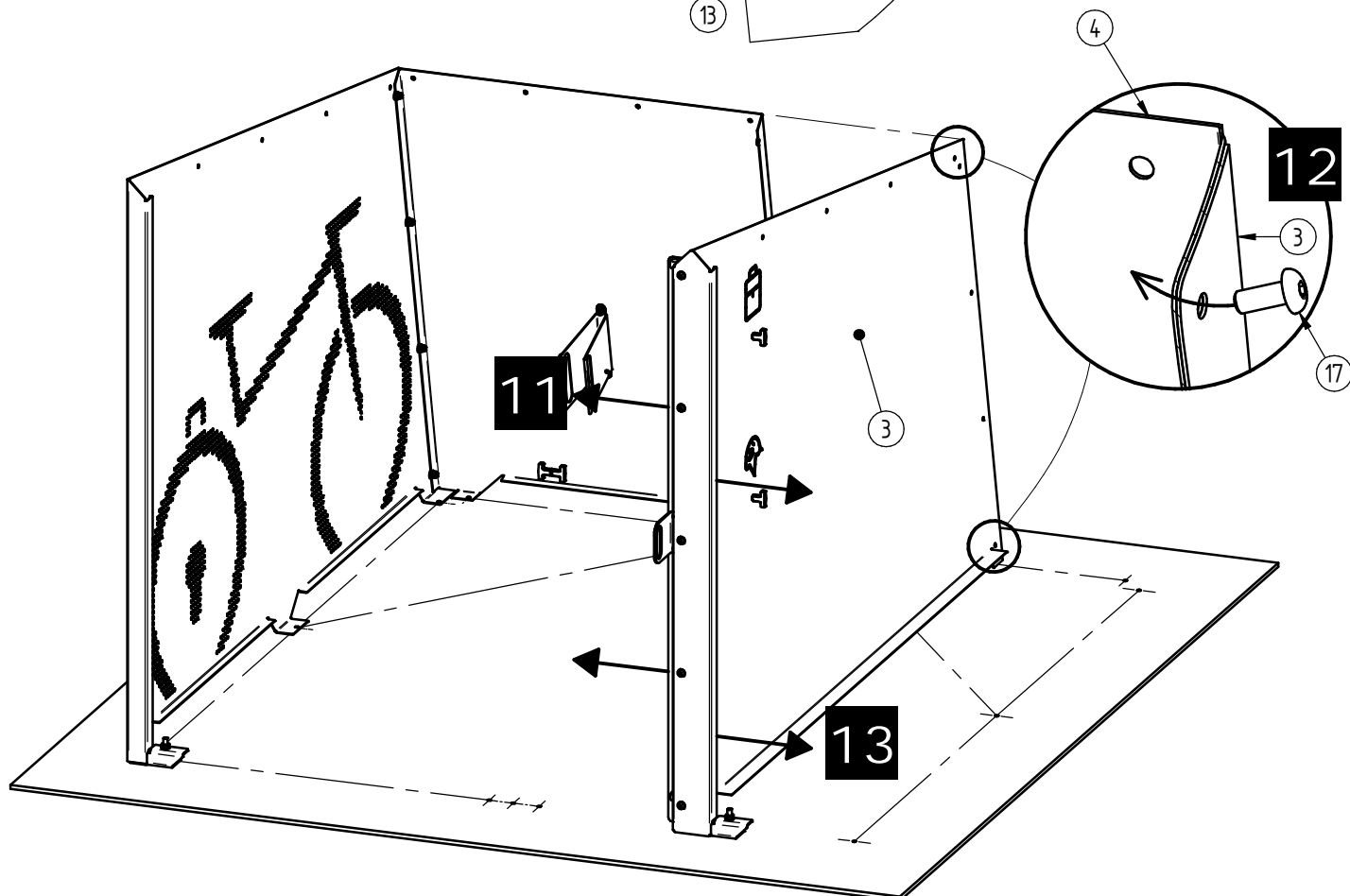
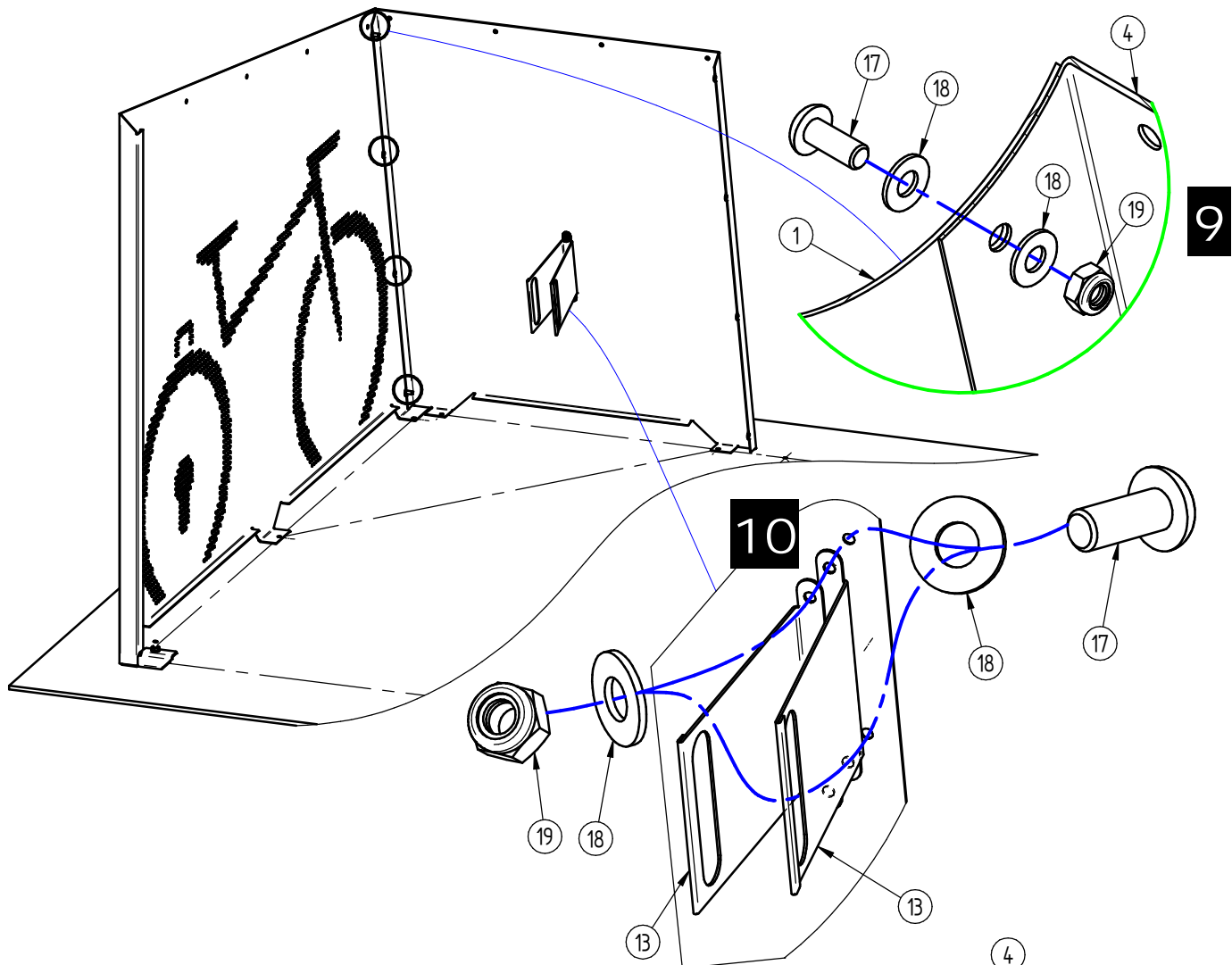

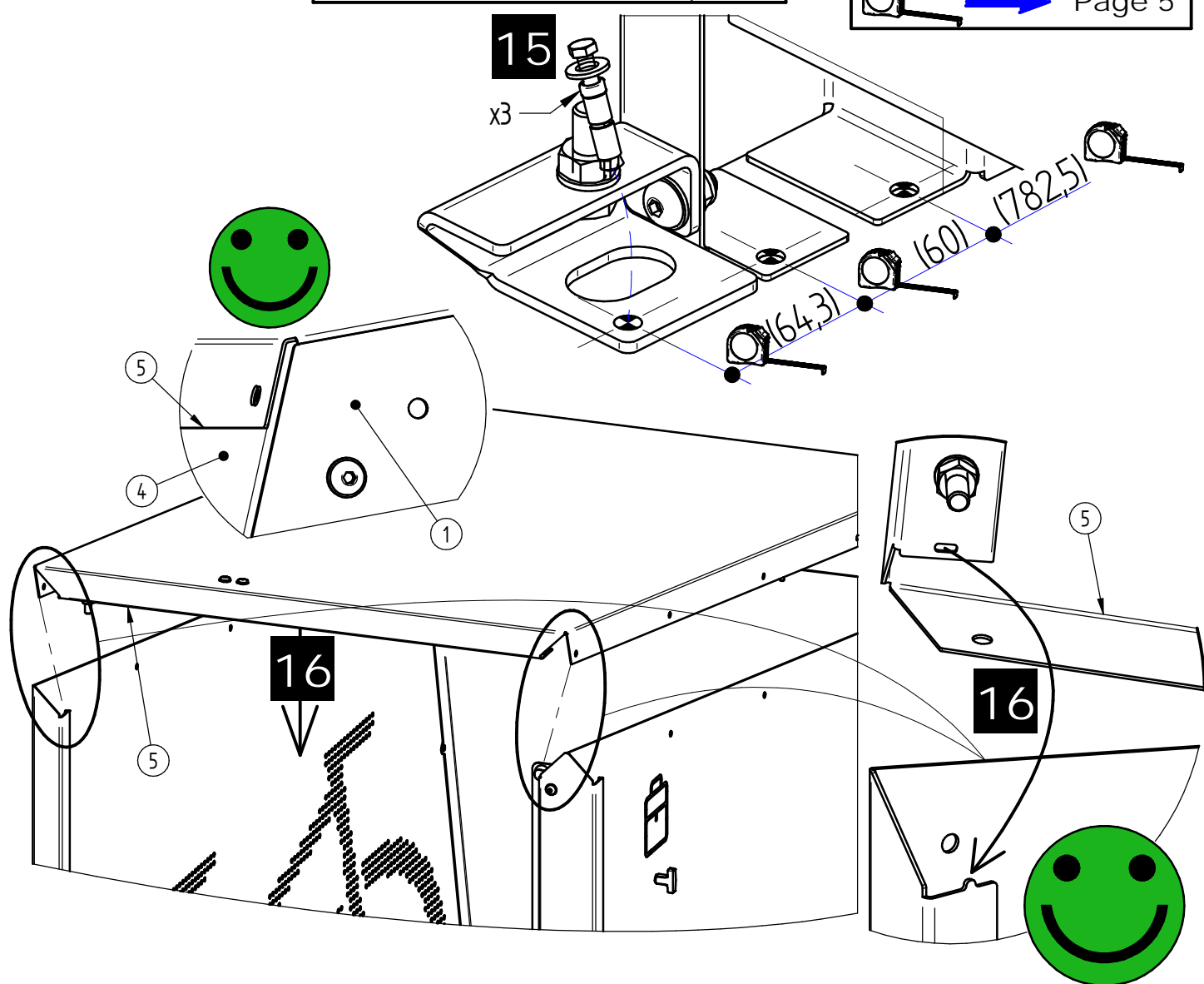
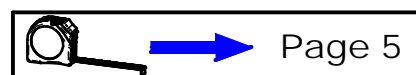
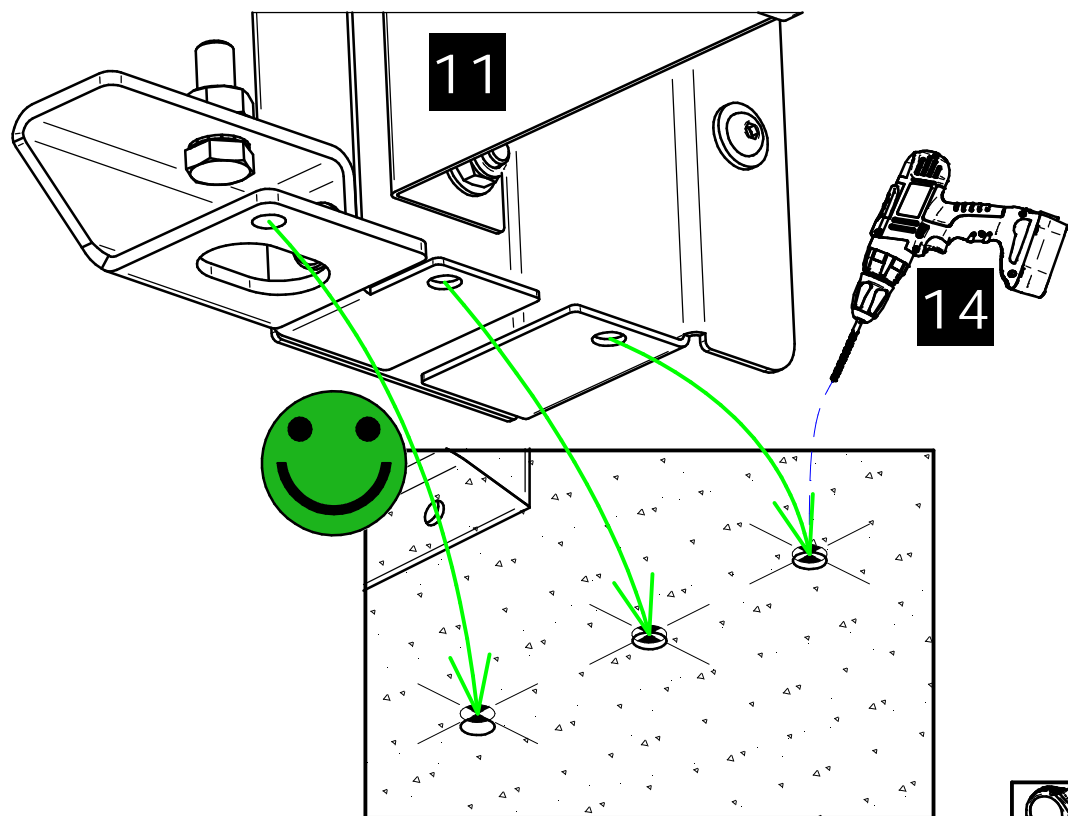

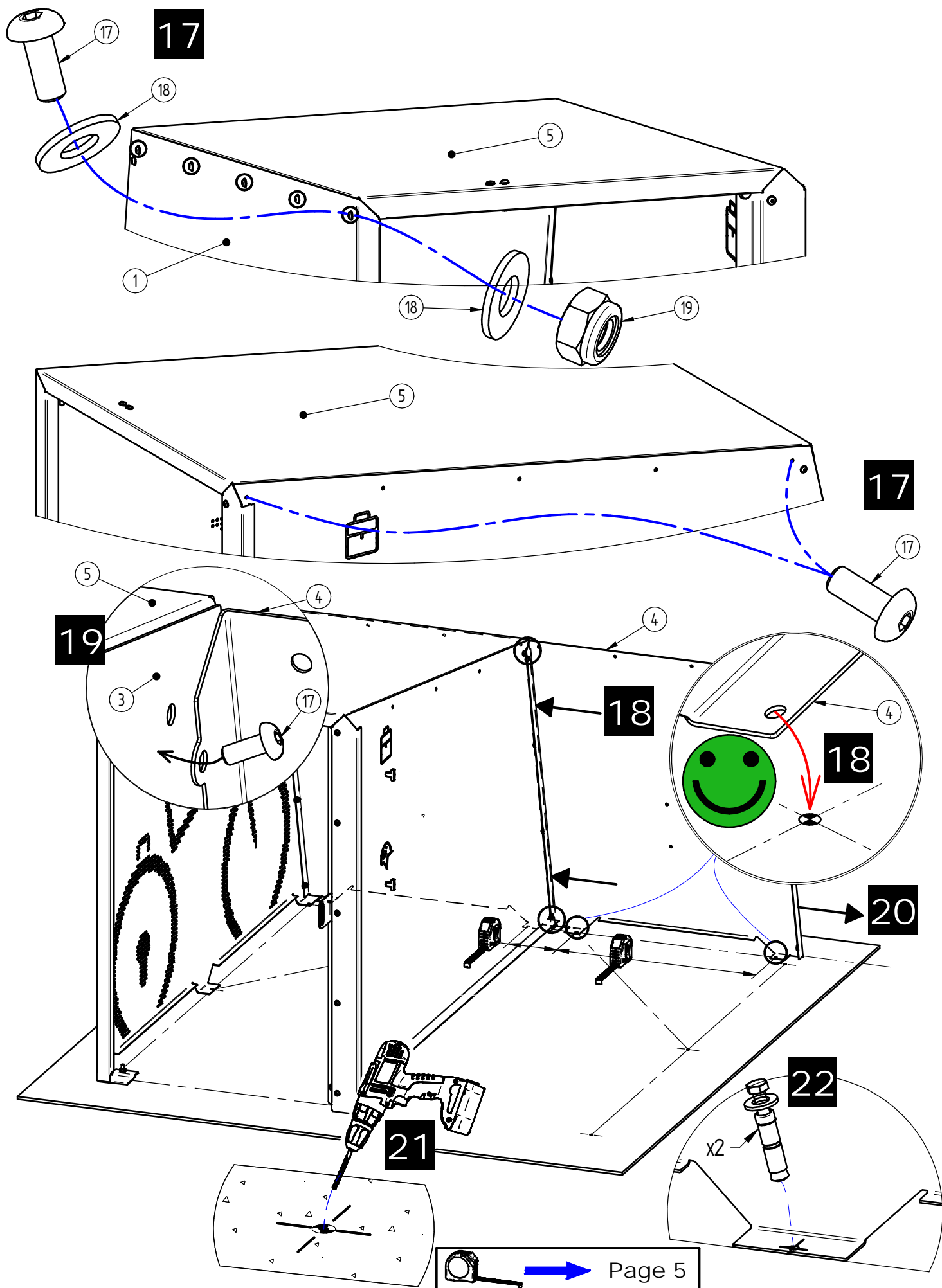

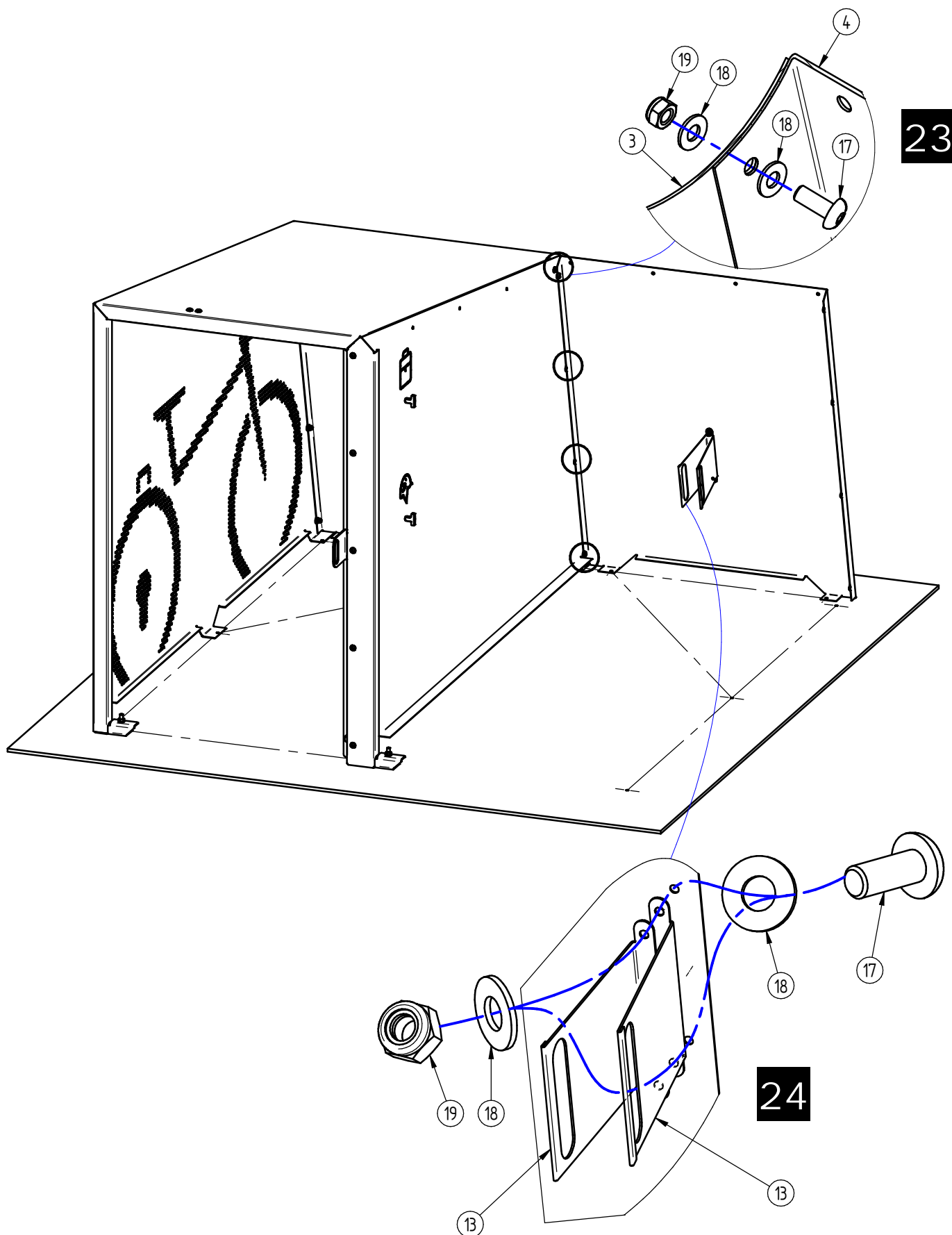

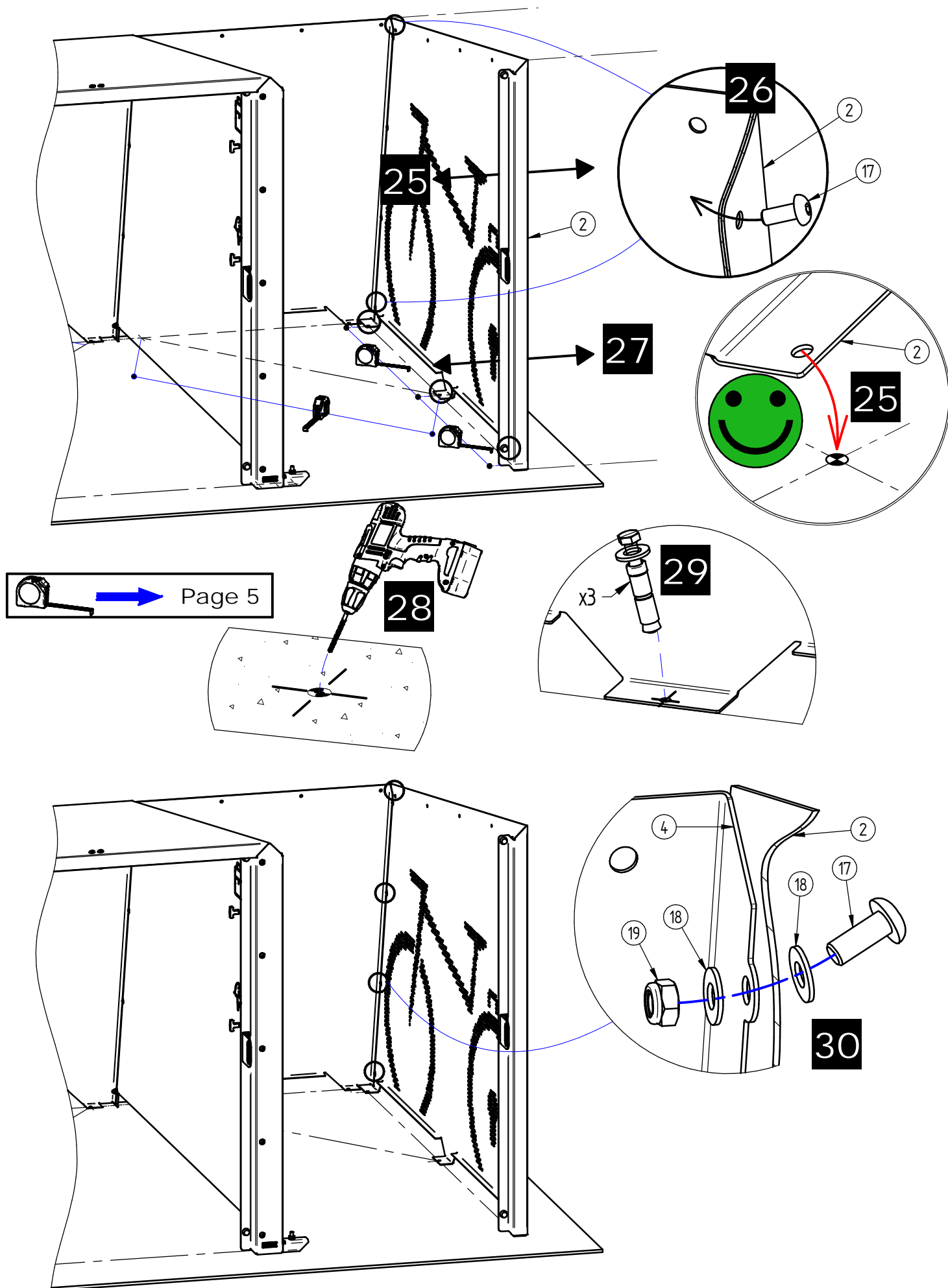

Page 5

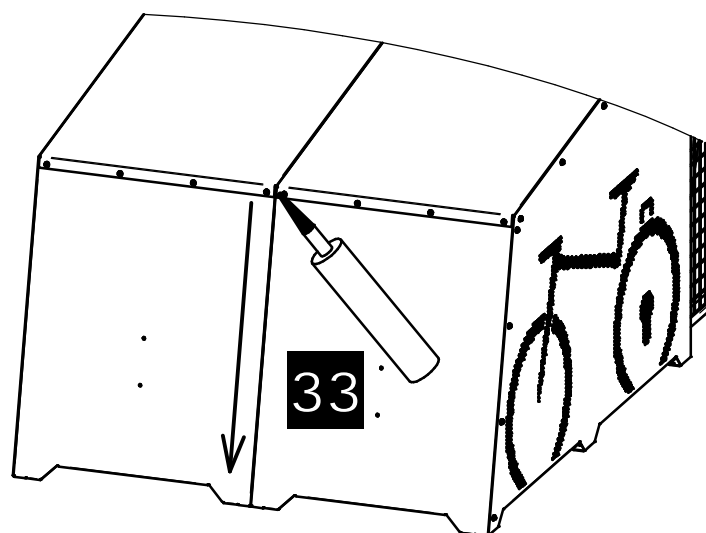
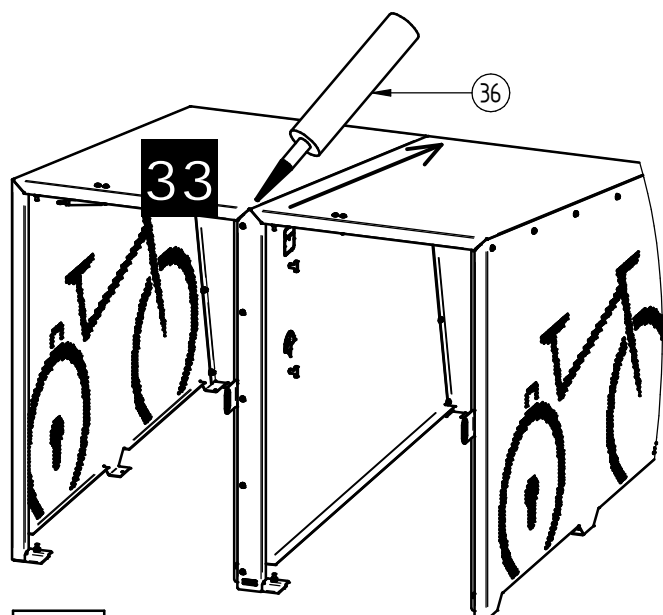
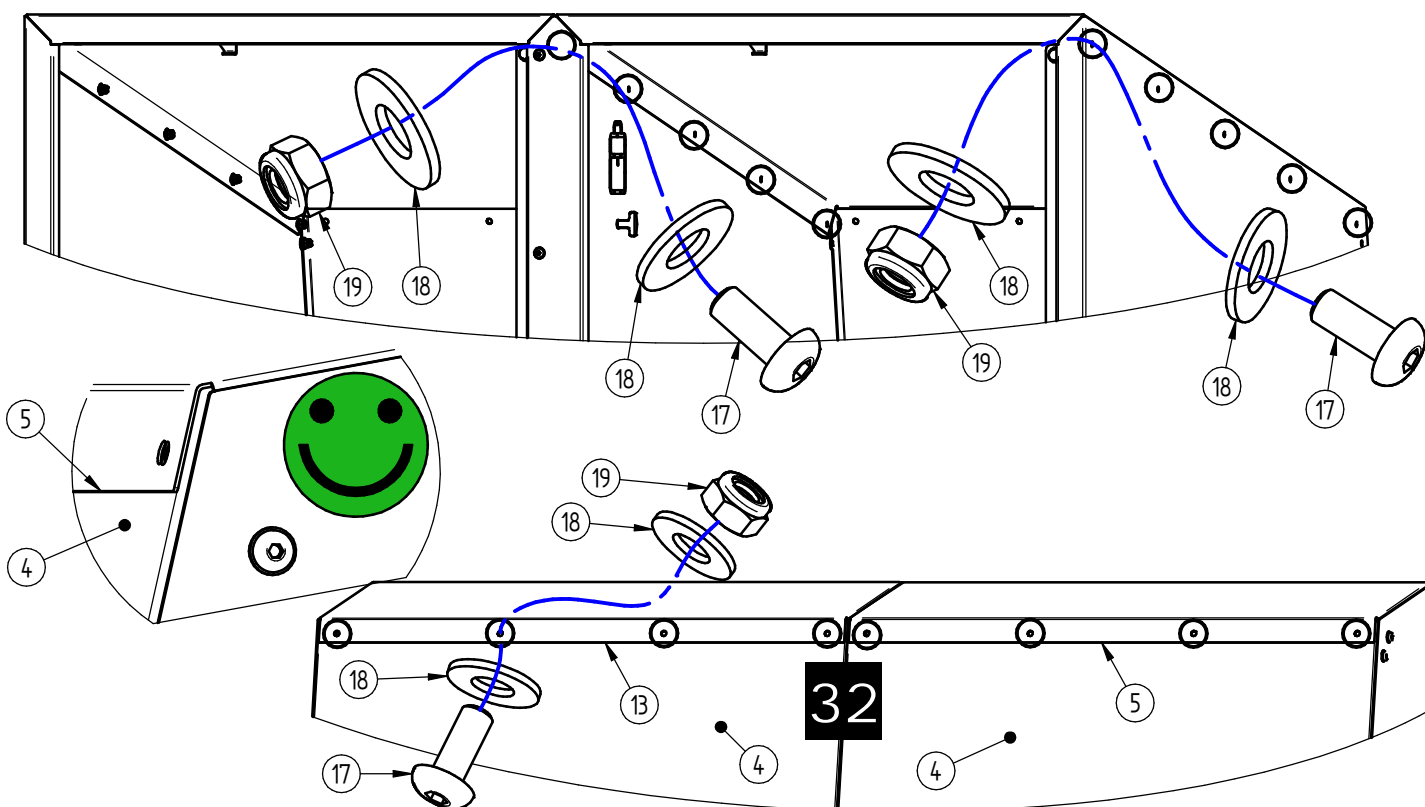
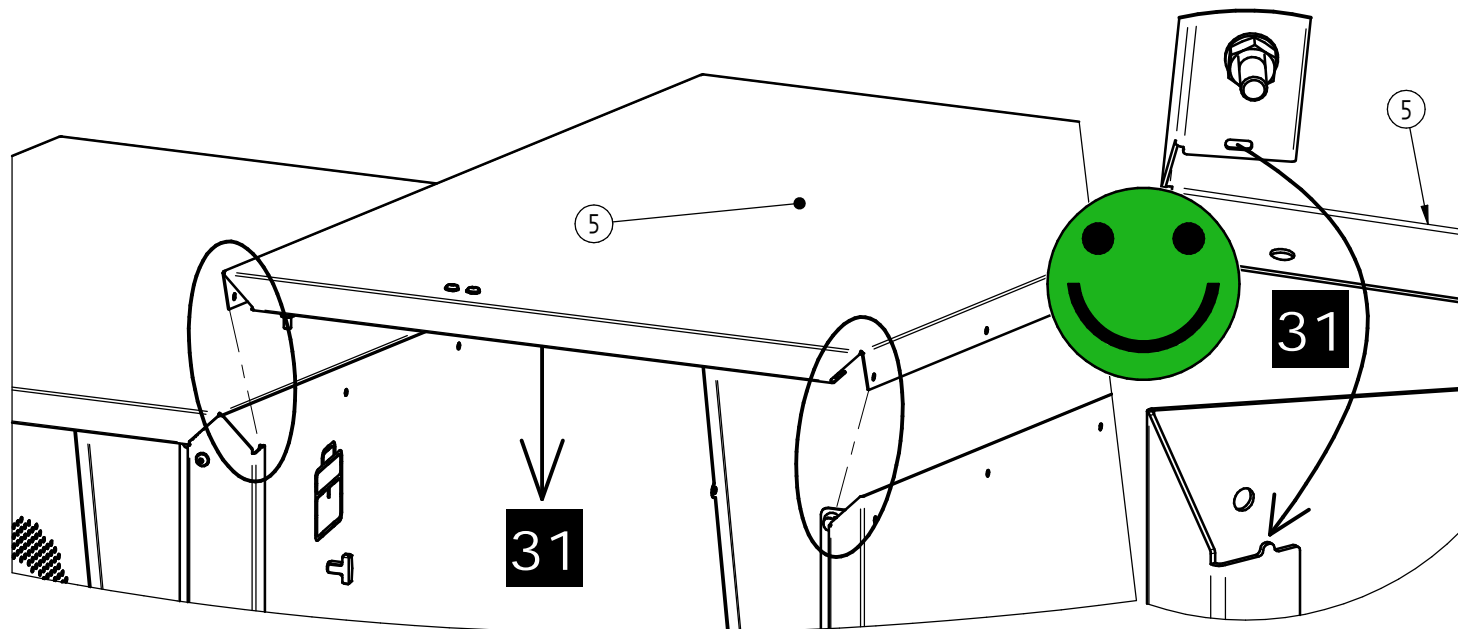

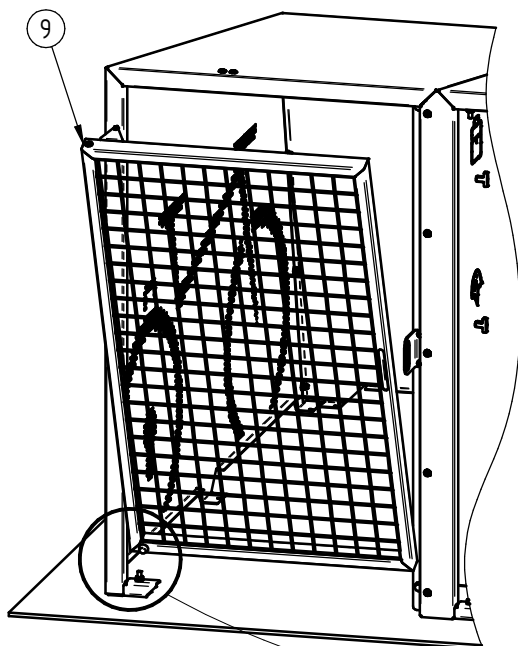

34

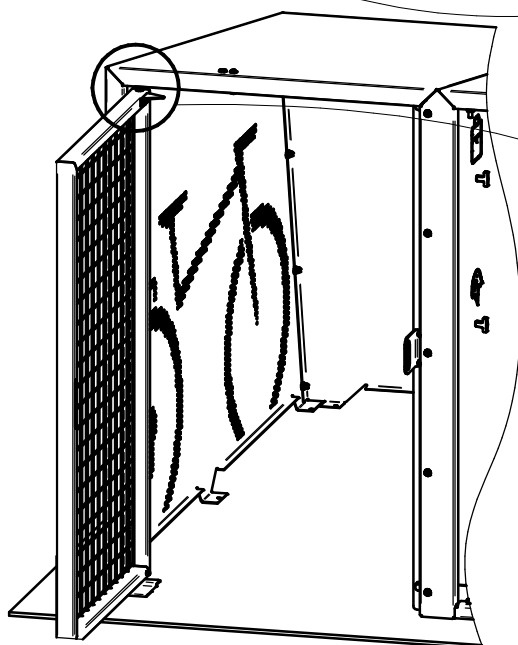
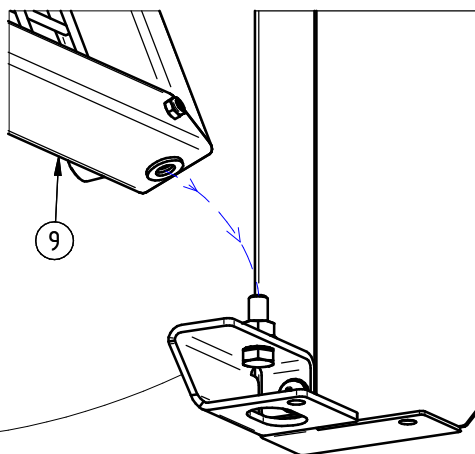

35

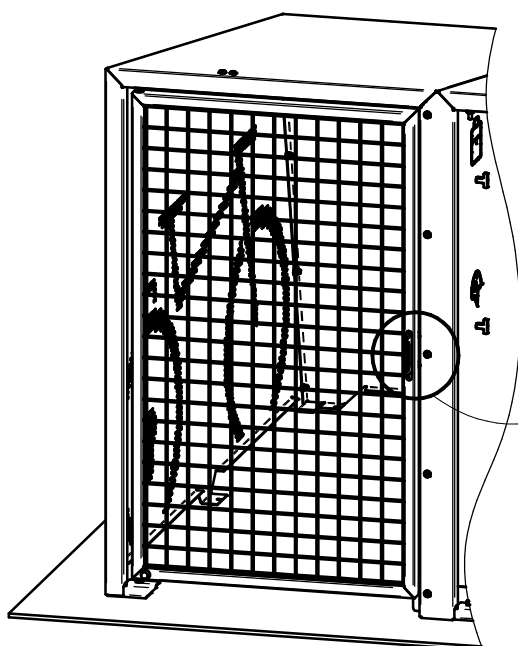
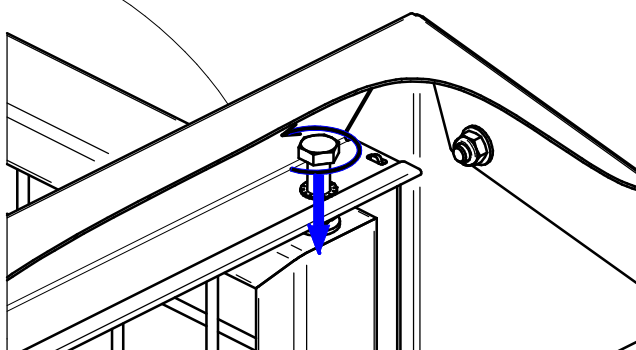

36

